

PERMIT

CITY OF NAPOLEON - BUILDING DEPARTMENT

255 West Riverview Avenue, Napoleon, Ohio 43545 - 419-592-4010

Permit No. 192-78 Issued 11/3/78
date

Job Location 122 Park Place
address

Lot n/a
sub-diy or legal discript

Issued By R.E. Johnson
building official

Owner Raymond Birtcher 599-1206
name tel.

Address 122 Park Place.

Agent Self
builder-eng.-etc. tel.

Address _____

Description of Use Install Wood Burning
Stove

Residential one
no. dwelling units

Commercial _____ Industrial _____

New _____ Add'n. XX Alter _____ Remodel _____

Mixed Occupancy _____

Change of Occupancy _____

Estimated Cost \$ 750.00

| FEES | BASE | PLUS | TOTAL |
|--|---------------------------------------|------|--------|
| <input checked="" type="checkbox"/> BUILDING | \$6.00 | | \$6.00 |
| <input type="checkbox"/> ELECTRICAL | | | |
| <input type="checkbox"/> PLUMBING | | | |
| <input type="checkbox"/> MECHANICAL | | | |
| <input type="checkbox"/> DEMOLITION | | | |
| <input type="checkbox"/> ZONING | | | |
| <input type="checkbox"/> SIGN | | | |
| WATER TAP | | | |
| SEWER TAP | | | |
| TEMP. ELECT. | | | |
| ADDITIONAL PLAN REVIEW | Struct. _____ hrs Elect. _____ hrs | | |
| TOTAL FEES..... | | | \$6.00 |
| LESS MIN. FEES PAID _____ date _____ | | | 0 |
| BALANCE DUE..... | | | \$6.00 |

ZONING INFORMATION

| district | lot dimensions | area | front yd | side yds | rear yd |
|----------|----------------|---------------|-----------|--------------------------|-----------|
| max hgt | no pkg spaces | no ldg spaces | max cover | petition or appeal req'd | date appr |

WORK INFORMATION:

Size: Length _____ Width _____ Stories _____ Ground Floor Area _____
Height _____ Building Volume (for demo. permit) _____ cu. ft.

Electrical: _____ brief description

Plumbing: _____ brief description

Mechanical: _____ brief description

Sign: _____ Dimensions _____ Sign Area _____
type

Additional Information: CALL FOR FINAL INSPECTION: INSTALL IN ACCORDANCE WITH

MANUFACTURERS INSTRUCTIONS:

Date 11-9-78 Applicant Signature Walter Birtcher
owner-agent

INSPECTION RECORD

| | UNDERGROUND | | | ROUGH-IN | | | | | | FINAL | | |
|-------------------|--|------|----|--|------|----|---|------|----|---------------------------------|------|----|
| | Type | Date | By | Type | Date | By | Type | Date | By | Type | Date | By |
| PLUMBING | Building Drains | | | Drainage, Waste & Vent Piping | | | Indirect Waste | | | Drainage, Waste & Vent Piping | | |
| | Water Piping | | | | | | | | | Backflow Prevention | | |
| | Building Sewer | | | Water Piping | | | Condensate Lines | | | Water Heater | | |
| | | | | | | | | | | | | |
| | Sewer Connection | | | | | | | | | FINAL APPROVAL | | |
| MECHANICAL | Refrigerant Piping | | | Refrigerant Piping | | | Chimney(s) | | | Grease Exhaust System | | |
| | | | | Duct Furnace(s) | | | Fire Dampers | | | Air Cond. Unit(s) | | |
| | Ducts/ Plenums | | | Ducts/ Plenums | | | <input type="checkbox"/> Radiant Htr(s) <input type="checkbox"/> Unit Htr(s) | | | Refrigeration Equipment | | |
| | | | | Duct Insulation | | | Pool Heater | | | Furnace(s) | | |
| | | | | Combustion Products Vents | | | Ventilation <input type="checkbox"/> Supply <input type="checkbox"/> Exhst. | | | FINAL APPROVAL | | |
| ELECTRICAL | Conduits & or Cable | | | Conduits/ Cable | | | <input type="checkbox"/> Range <input type="checkbox"/> Dryer | | | Temp Service Temp Lighting | | |
| | Grounding & or Bonding | | | Rough Wiring | | | <input type="checkbox"/> Generator(s) <input type="checkbox"/> Motors | | | Fixtures Lampholders | | |
| | Floor Ducts Raceways | | | Service Panel Switchboard | | | <input type="checkbox"/> Water Htr <input type="checkbox"/> Welder | | | Signs | | |
| | Service Conduit | | | Busways Ducts | | | <input type="checkbox"/> Heaters <input type="checkbox"/> Heat Cable | | | Electric Mtr. Clearance | | |
| | Temporary Power Pole | | | Subpanels | | | <input type="checkbox"/> Duct Htr(s) <input type="checkbox"/> Furnace(s) | | | FINAL APPROVAL | | |
| BUILDING | Location, Set-backs, Esmt(s) | | | Exterior Wall Construction | | | Roof Covering Roof Drainage | | | Smoke Detector | | |
| | Excavation | | | | | | Exterior Lath | | | Demolition (sewer cap) | | |
| | Footings & Reinforcing | | | | | | <input type="checkbox"/> Interior Lath <input type="checkbox"/> Wallboard | | | | | |
| | Floor Slab | | | Interior Wall Construction | | | Fire Wall(s) | | | Building or Structure | | |
| | Foundation Walls | | | Columns & Supports | | | Fireplace Chimney | | | | | |
| | Sub-soil Drain | | | Crawl Space <input type="checkbox"/> Vent <input type="checkbox"/> Access | | | Attic <input type="checkbox"/> Vent <input type="checkbox"/> Access | | | | | |
| | Piles | | | Floor System(s) | | | | | | FINAL APPROVAL BLDG. DEPT. | | |
| | | | | Roof System | | | Special Insp Reports Rec'd | | | Certificate of Occupancy Issued | | |
| ADDITIONAL | INSPECTIONS, CORRECTIONS, ETC. | | | | | | INSPECTIONS, CORRECTIONS, ETC. | | | | | |
| | Approved 12" from face of Brick to BACK of Stove | | | | | | | | | | | |
| | | | | | | | | | | | | |
| | | | | | | | | | | | | |

11/17/10 [Signature]

11/19/10 [Signature]

Ray Birtcher
122 Park Pl
Napoleon Ohio
599-1206
4/12 Pitch

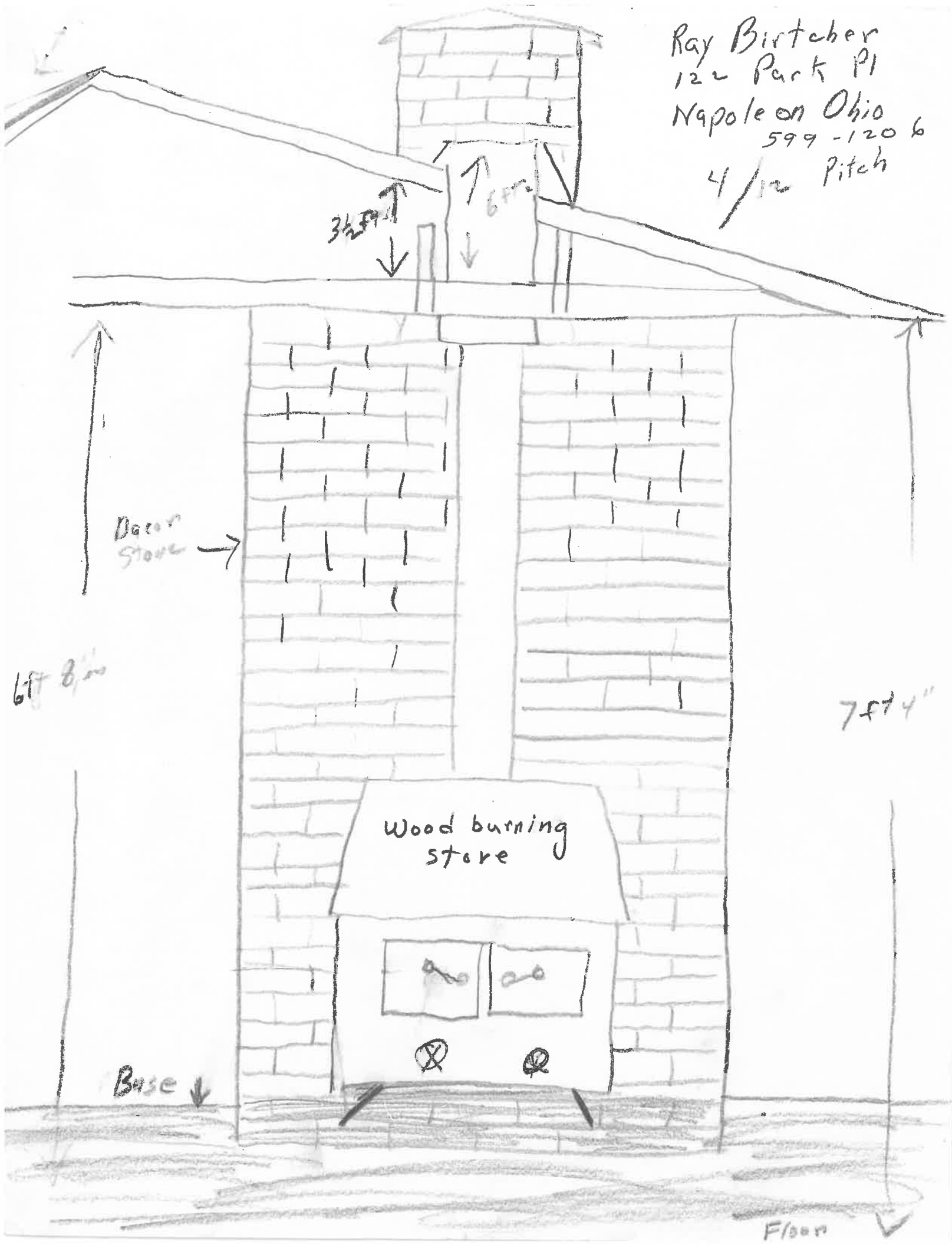

3 1/2 FT
6 FT

Decor Stove

6 ft 8 in

7 ft 4 in

Wood burning stove

Base

Floor



Base

1/8"

6 ft

4 in

1/4"

3/4 Plywood

(Top)
Slate

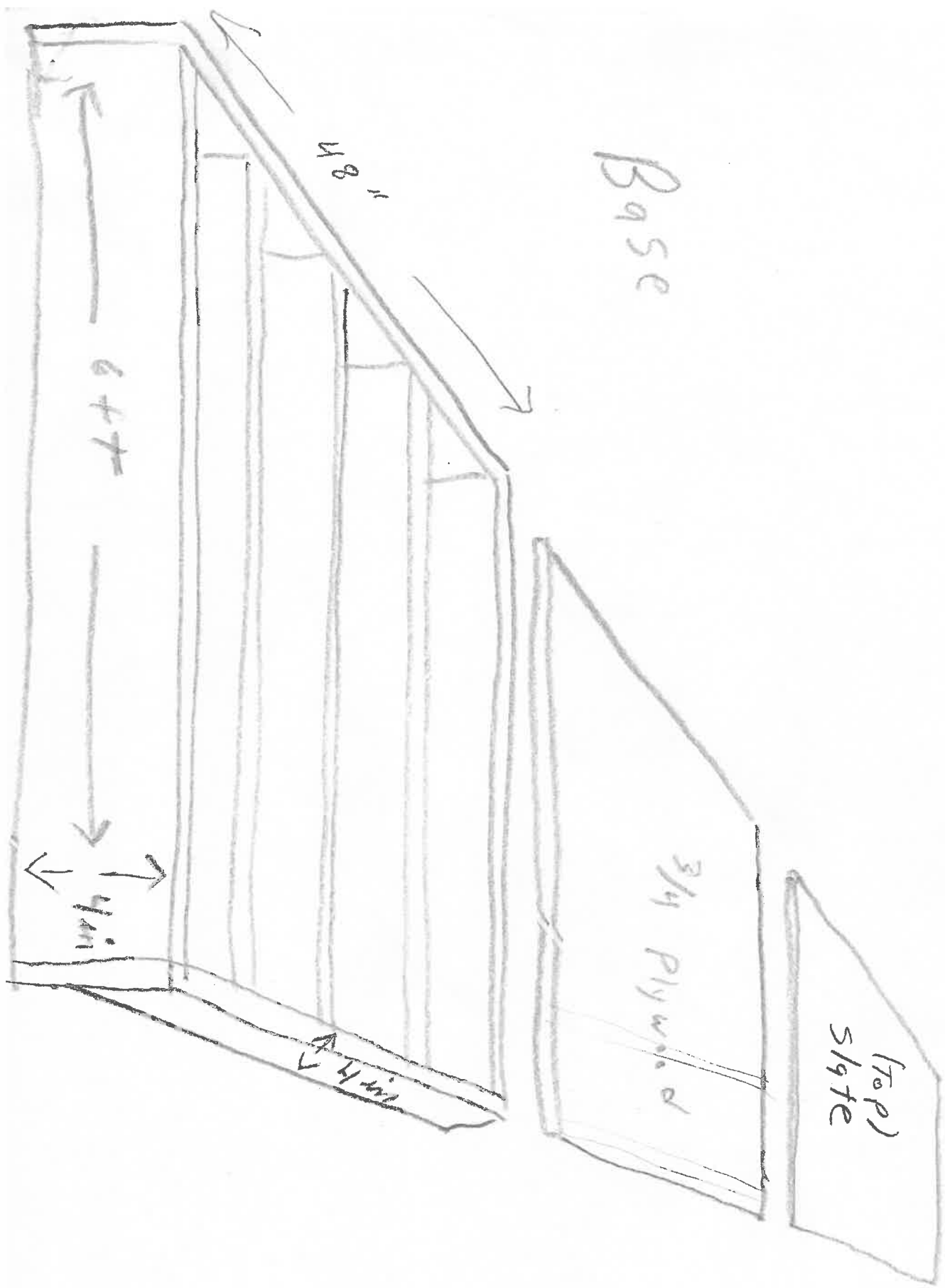

Wall

← 6 ft →

← 2 in. Air space behind

7 ft 4 in

Asbestos
1/2"

Wall

